



CLIVEPEARCE
Now you're moving

2 Bedrooms

House - End Terrace

Guide Price

£265,000

Located in

Truro



www.clivepearceproperty.com



Bownder Hynshorn

Truro | | TR1 2GS



A modern two double bedroom energy efficient end terrace family home with two parking spaces and rear garden within close proximity of the city centre.

Bownder Hynshorn

£265,000 Freehold



- Quiet cul de sac
- Very energy efficient
- Two double bedrooms
- Garden with decking
- Modern throughout
- Edge of City Centre
- Parking for two vehicles
- Remainder of warranty
- End of terrace
- Ideal first buy or investment

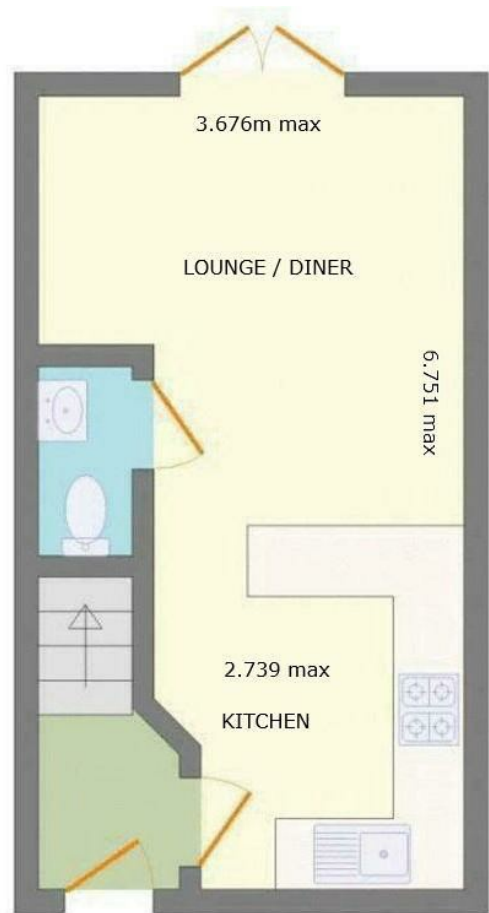
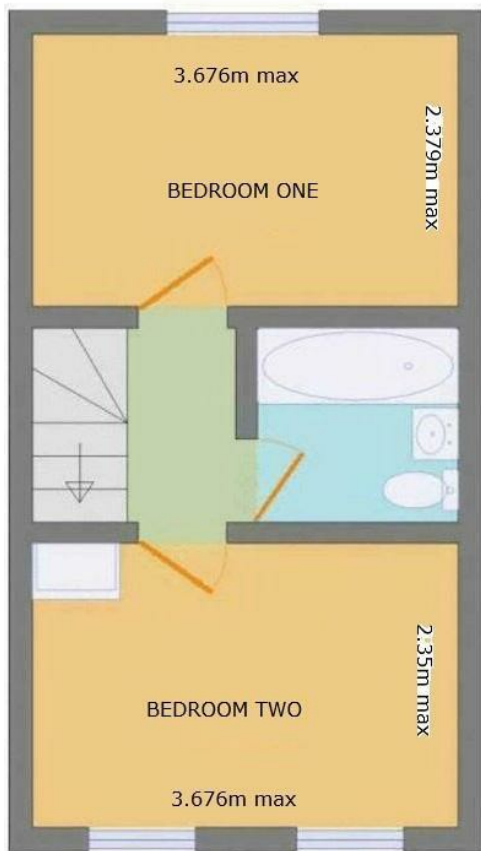

Council Tax Band B

Local Authority

Agents Note: Whilst every care has been taken to prepare these particulars, they are for guidance purposes only. All measurements are approximate and are for general guidance purposes only and whilst every care has been taken to ensure their accuracy, they should not be relied upon and potential buyers/tenants are advised to recheck the measurements.

Energy Efficiency Rating		
	Current	Potential
Very energy efficient - lower running costs		
(92 plus) A		97
(81-91) B	82	
(69-80) C		
(55-68) D		
(39-54) E		
(21-38) F		
(1-20) G		
Not energy efficient - higher running costs		
England & Wales	EU Directive 2002/91/EC	

31 Lemon Street
Truro
Cornwall
TR1 2LS



CLIVEPEARCE
Now you're moving

hello@clivepearceproperty.com

01872 272622

www.clivepearceproperty.com